



Portland Public Schools

# Ida B. Wells High School Modernization



Community Design Workshop #4  
September 22, 2024



DESIGN TEAM HERE TODAY



Donna Bezio  
PPS



Rolando Aquilizan  
PPS



Stefée Knudsen  
Bora



Amelie Reynaud  
Bora



Amy Running  
Bora



Rhonda Teeny  
After Bruce

# AGENDA

- Introduction and Objectives** 00:02
- Community Agreements** 00:02
- Where Are We Now + Getting Here** 00:6
- Project Design Updates** 00:20
- Open House** 01:30

meeting notes from the previous CDWs and DAG meetings are posted on the PPS Bond website!

## STATIONS

General  
Updates &  
Questions

Site  
Design

Exterior  
Look & Feel

Plan  
Updates

Comfortable  
+Welcoming  
Spaces

Commons  
Design

Community  
Engagement

## UPDATES SINCE THE LAST OPEN HOUSE (MAY)

### Review the developing site configurations

- Development of walkways and fields
- Consideration of grandstands on east or west side of field

### Review the developing building design

- Survey on exterior “Look & Feel”
- Survey on “Comfortable & Welcoming spaces”
- Development of floor plans
- Development of Commons (Cafeteria and more)
- **Feedback: Does the design support the Project Vision?**



**TAKE THE  
SURVEYS!!**

# Community Agreements + Community Engagement



## COMMUNITY AGREEMENTS

- We embrace student-first thinking.
- We approach conversations with curiosity and question our assumptions, understanding that multiple solutions or approaches can exist at the same time and all be true.
- We assume positive intent and respect one another through our words and actions.
- We understand that we all can't get what we want.
- We encourage a variety of voices in our process, and make space for different communication styles and preferences.

## Engagement Efforts

- Listening Session: All AB Audiences
- Insight Interviews: Students, Teachers, Faculty, Feeder Schools
- Watch out for more!

## Lessons Heard

- Reducing industry jargon can help people stay more engaged
- Keep the power dynamic balanced
- Be mindful of busy schedules & meet audiences where they are
- Dedicated space for affinity groups can provide safer spaces

## UPCOMING COMMUNITY LISTENING SESSIONS

- Gender Sexuality Alliance (GSA) club
- Muslim Student Association & Arab students
- Affinity Group leaders and student leaders of color
- Special Education teachers, staff, parents and caregivers
- Indigenous Alliance
- Parents of Color
- All After Bruce-led audiences

Email [rhonda@afterbruce.com](mailto:rhonda@afterbruce.com) to sign up



Where are we now?



PROJECT TIMELINE

2019  
Comprehensive  
Master Plan

2023-24  
Comprehensive  
Planning

**Schematic  
Design**

Design  
Development

Permit  
Documents

Ready for  
Construction!

We are HERE  
(just finishing)

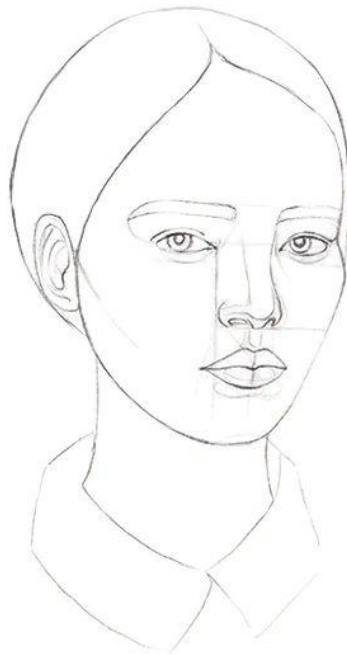
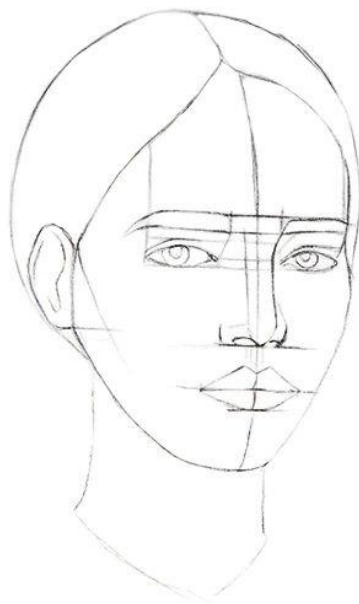
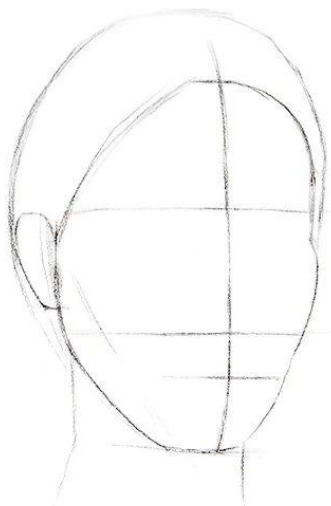
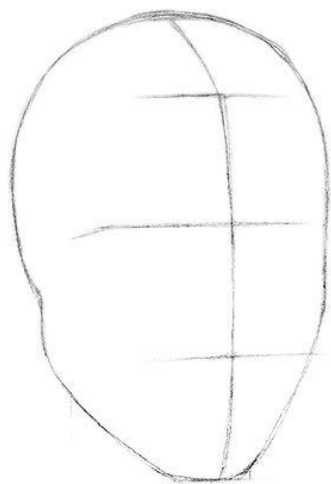

TYPICALLY  
18-24 MONTHS

TYPICALLY  
24-36 MONTHS

# PROJECT TIMELINE

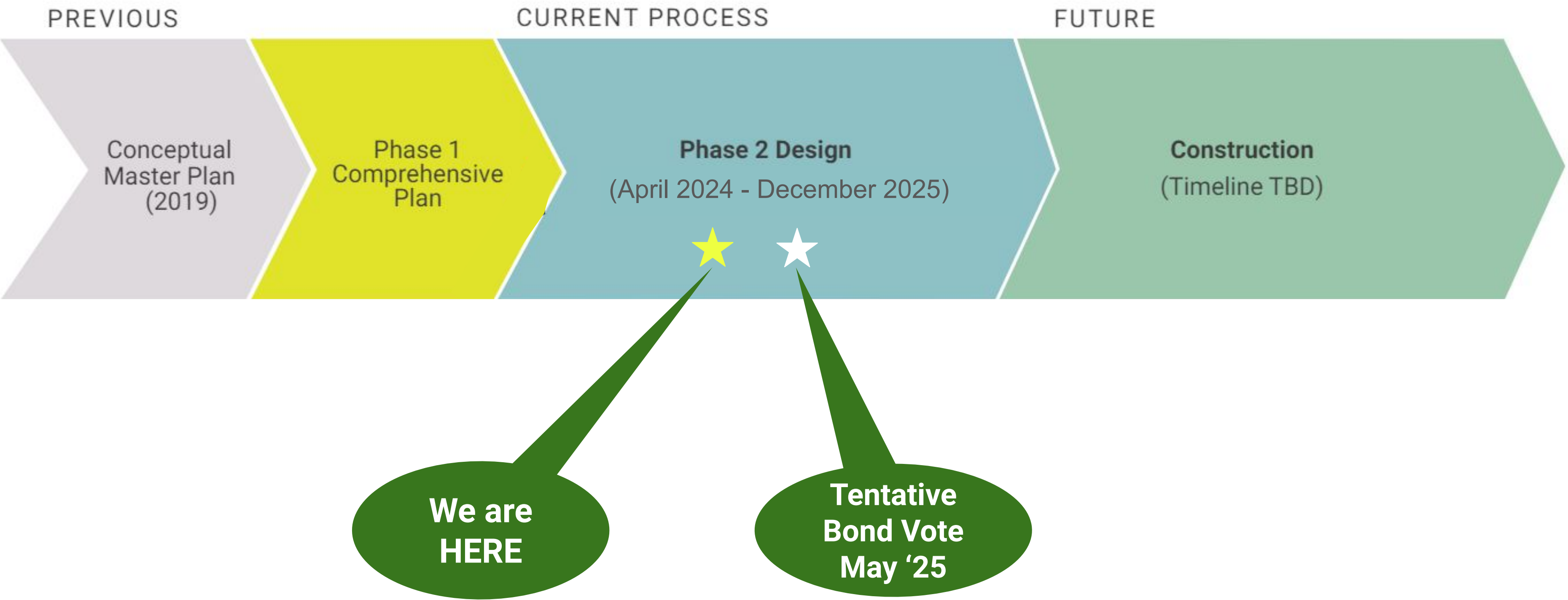

# Design History



PLANNING PHASE - KEY DESIGN DRIVERS

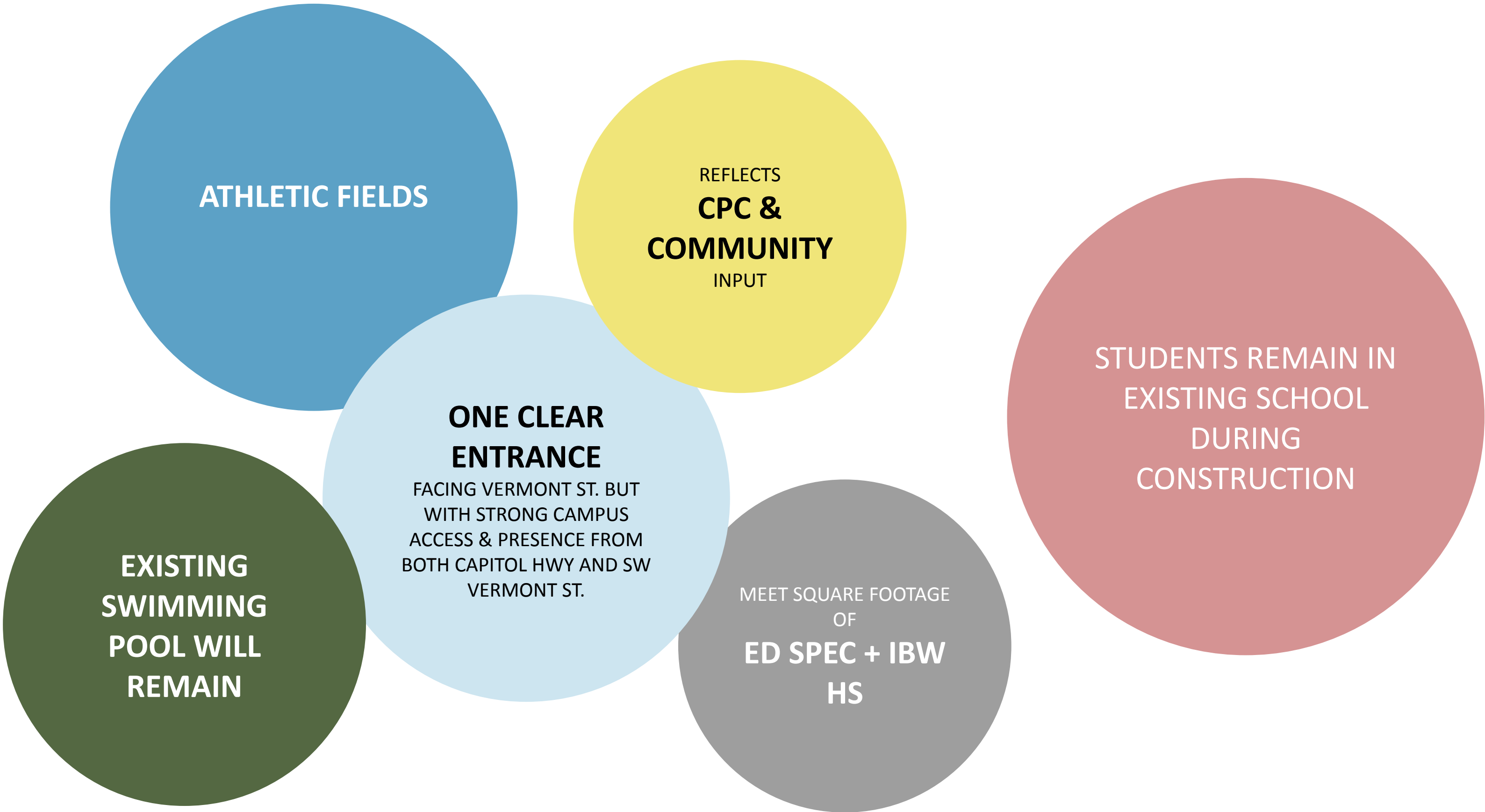

# SITE TOPOGRAPHY

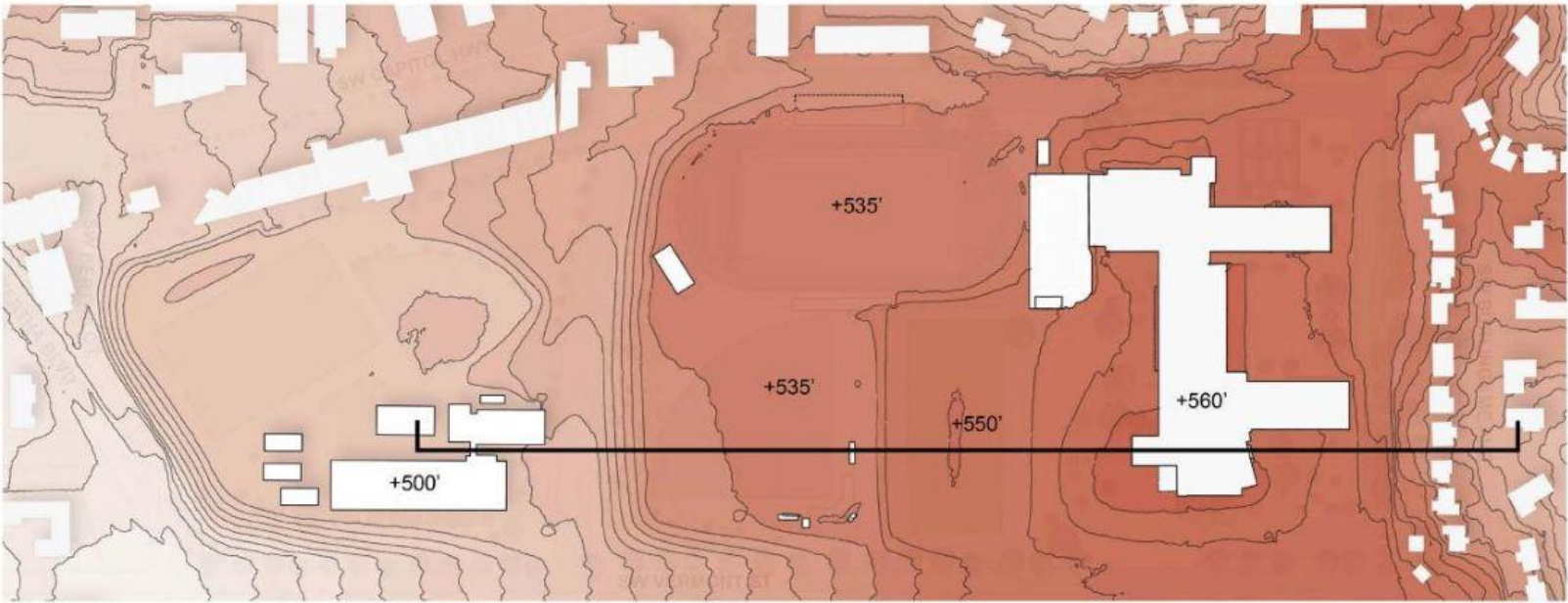

**DESIGN DRIVERS:**  
TOPOGRAPHY  
ENHANCE THE ECOLOGY OF THE SITE  
CONNECTIVITY

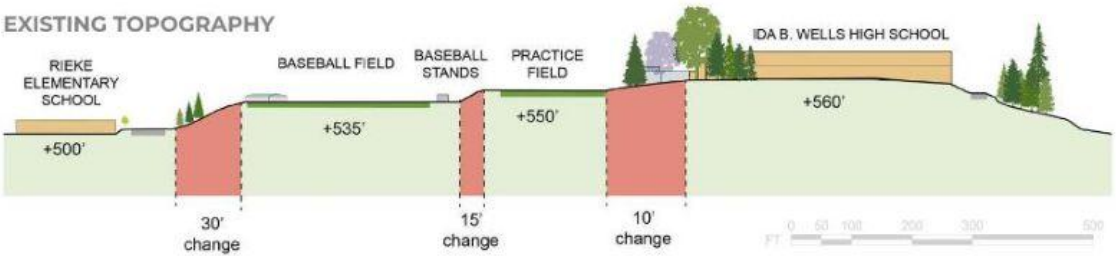

# PLANNING PHASE - FINAL OPTIONS

## SCHEME 1

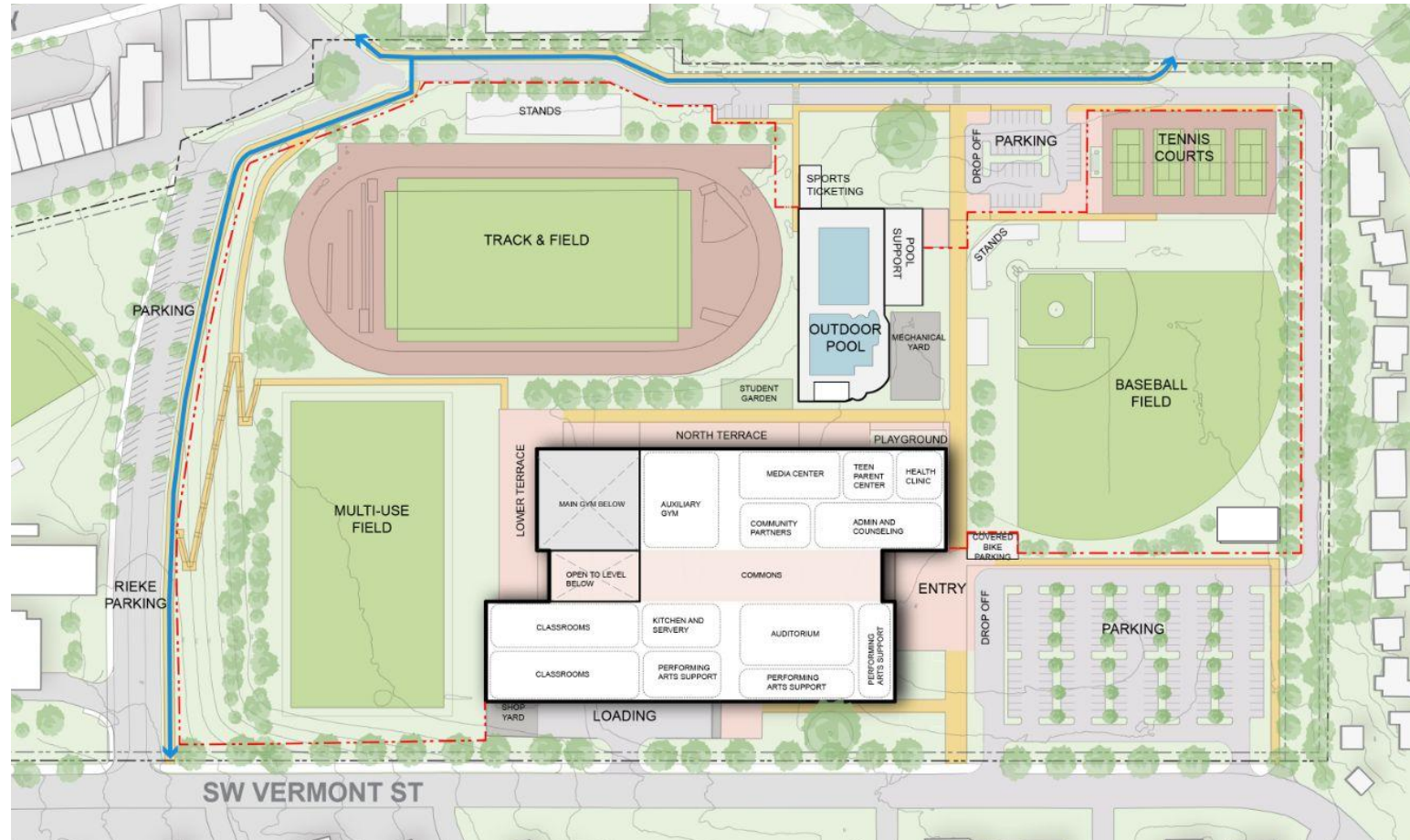

- Track & Field remains in place with improvements
- Minimal Track & Field disruption during construction
- Pathway connection to Rieke parking and fields
- Main parking lot and drop-off near building entry
- Vehicular connection between the two parking lots
- Separation between school and pool offers flexibility with building footprint
- 3-story building height

## SCHEME 2

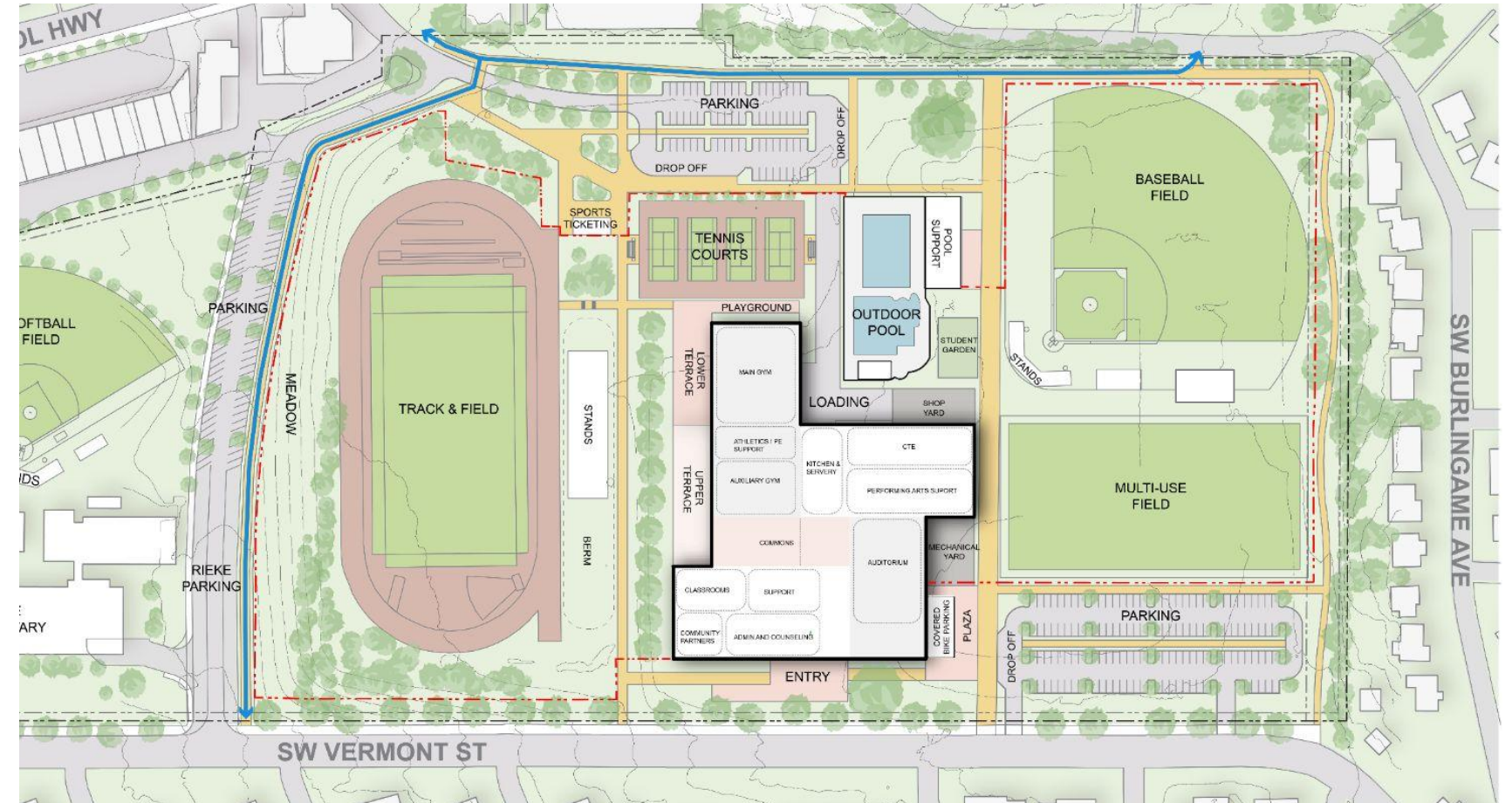

- Track & Field in optimal N-S orientation
- More space for construction staging
- Direct pedestrian connection to Capitol Highway
- Parking lots and drop-offs near Capitol Hwy and Vermont St.
- Vehicular access at opposite ends of building
- Less flexibility with building footprint due to pool and track locations
- 4-story building height

# BUILDING MASSING

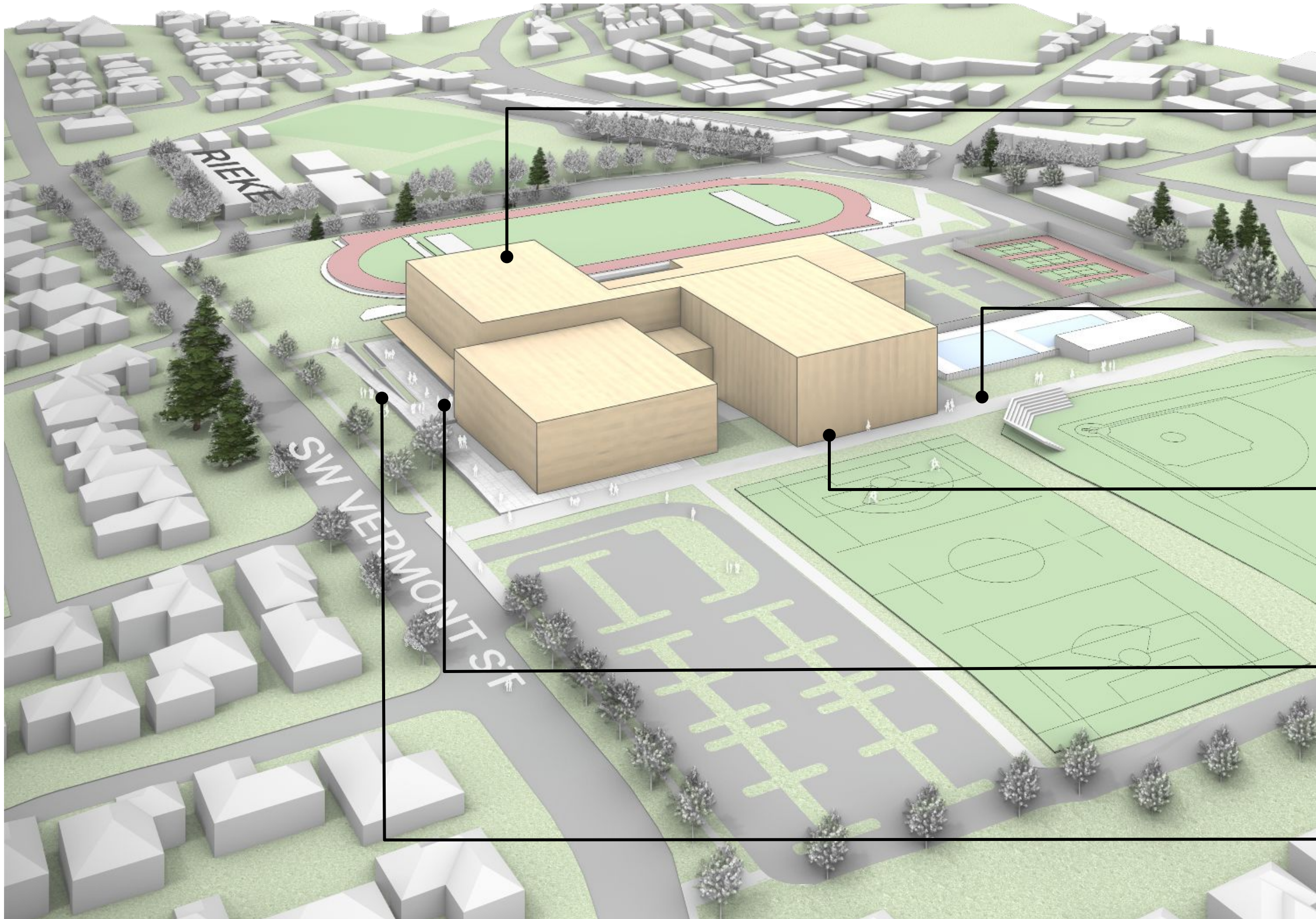

Building orientation and massing allows for **maximum daylighting and minimizes western sun exposure**, reducing building energy consumption and eliminating solar discomfort

Pathways through campus **connect to the SW Trails network and the broader business and residential district**, making the school a beacon of activity in SW Portland

Building massing is optimal for a timber structure, allowing for **reduced embodied carbon emissions, improved indoor air quality, and biophilic design** opportunities.

Main entrance faces Vermont St. with direct pathways **connecting it to both campus approaches** and parking lots

Site configuration allows for universal accessibility, going beyond code to create a **physical place of inclusion** at every scale

## DAG MEETINGS

- DAG #1: May 20th
  - Community Agreements
- DAG #2: June 20th
  - Project Vision + Metaphor
  - Exterior Look & Feel
- DAG #3: August 14th
  - Site Design
  - Exterior Studies
- DAG #4: September 18th
  - Comfortable & Welcoming Spaces
  - Commons (Cafeteria) Studies



Since we  
last met...

## PROJECT VISION



The new Ida B. Wells High School will embody the legacy of its namesake, shining a light on her commitment to truth, transparency, and justice.

## PROJECT VISION

Bold  
Innovative  
Change  
Truth  
Lifting Up Voices  
Persistence  
Determination  
Honor  
Connection  
Creative  
Community  
Support  
Cultural Heritage  
Knowledge sharing  
Accessible to all  
Gathering  
Forums

Action

Justice

Advocacy

Pride

Feminism

Empathy

Courage

Inclusive

Empowerment

Breaking Barriers

Welcoming

Diversity

Kindness

Perseverance

Values

Free Speech

# Site Design Update



SITE PLAN - SCHEMATIC DESIGN

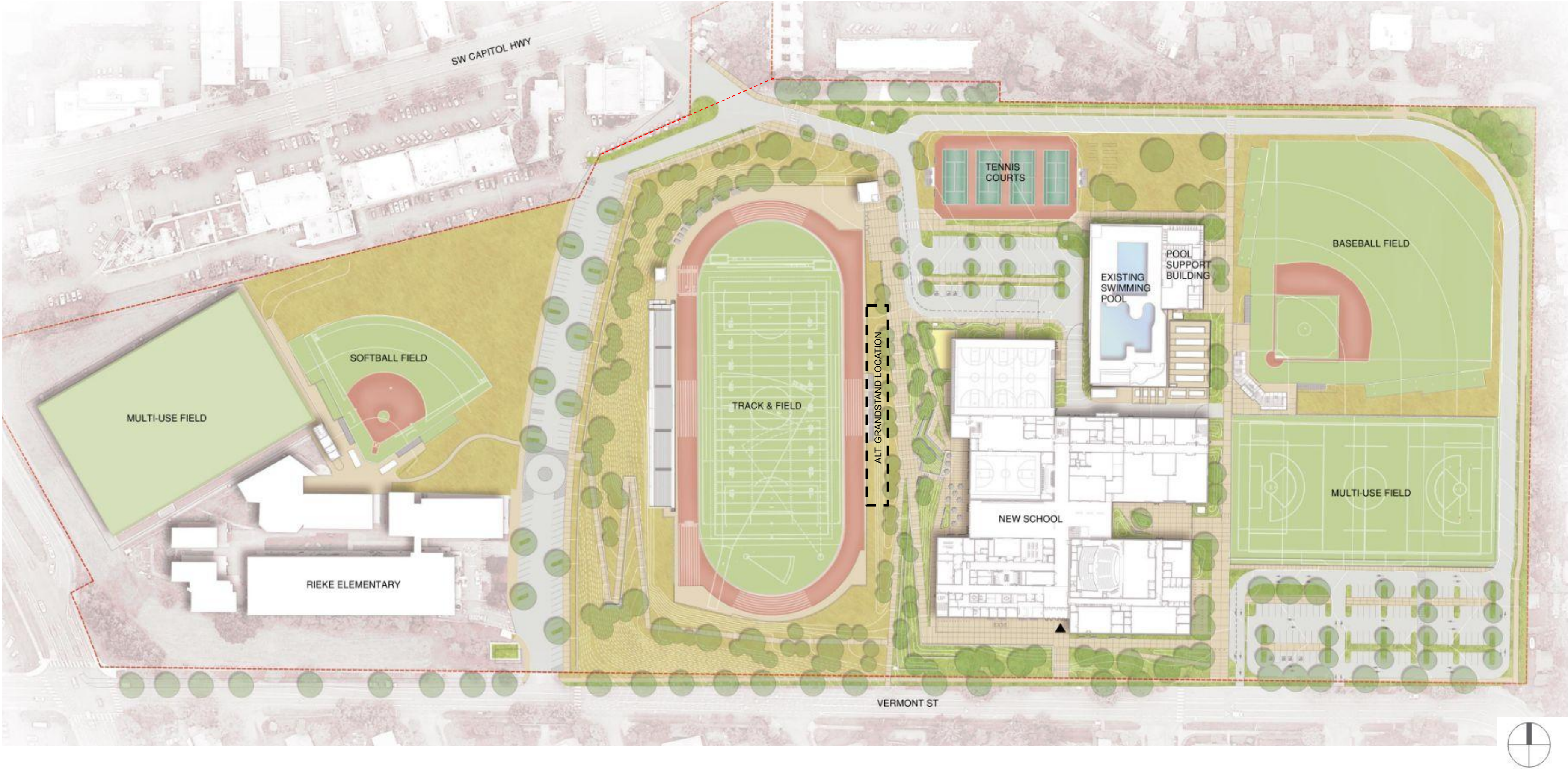

# GRANDSTAND LOCATION OPTIONS

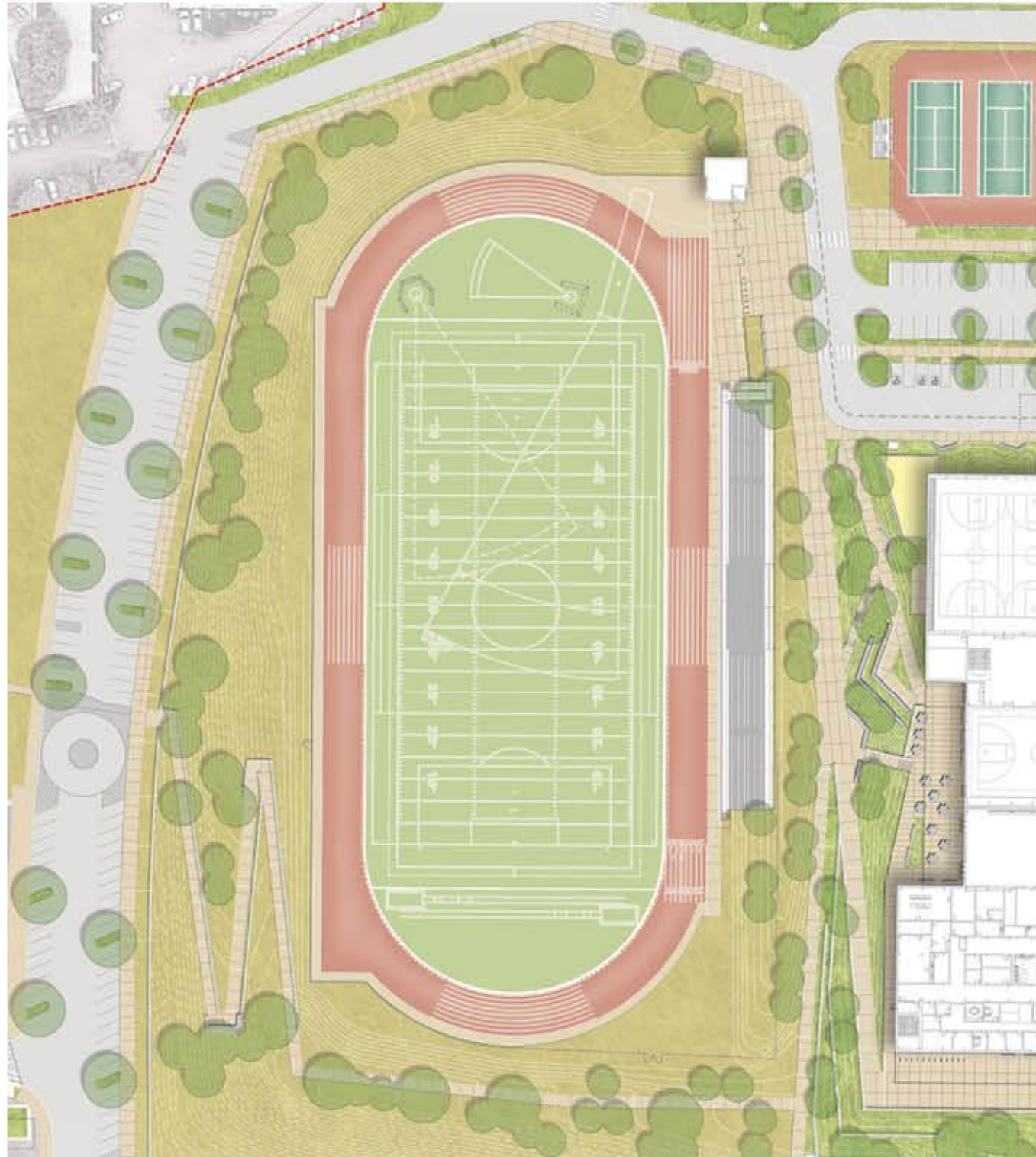

Option - East



Option - West

# Plan Development



FLOOR PLAN ORGANIZATION

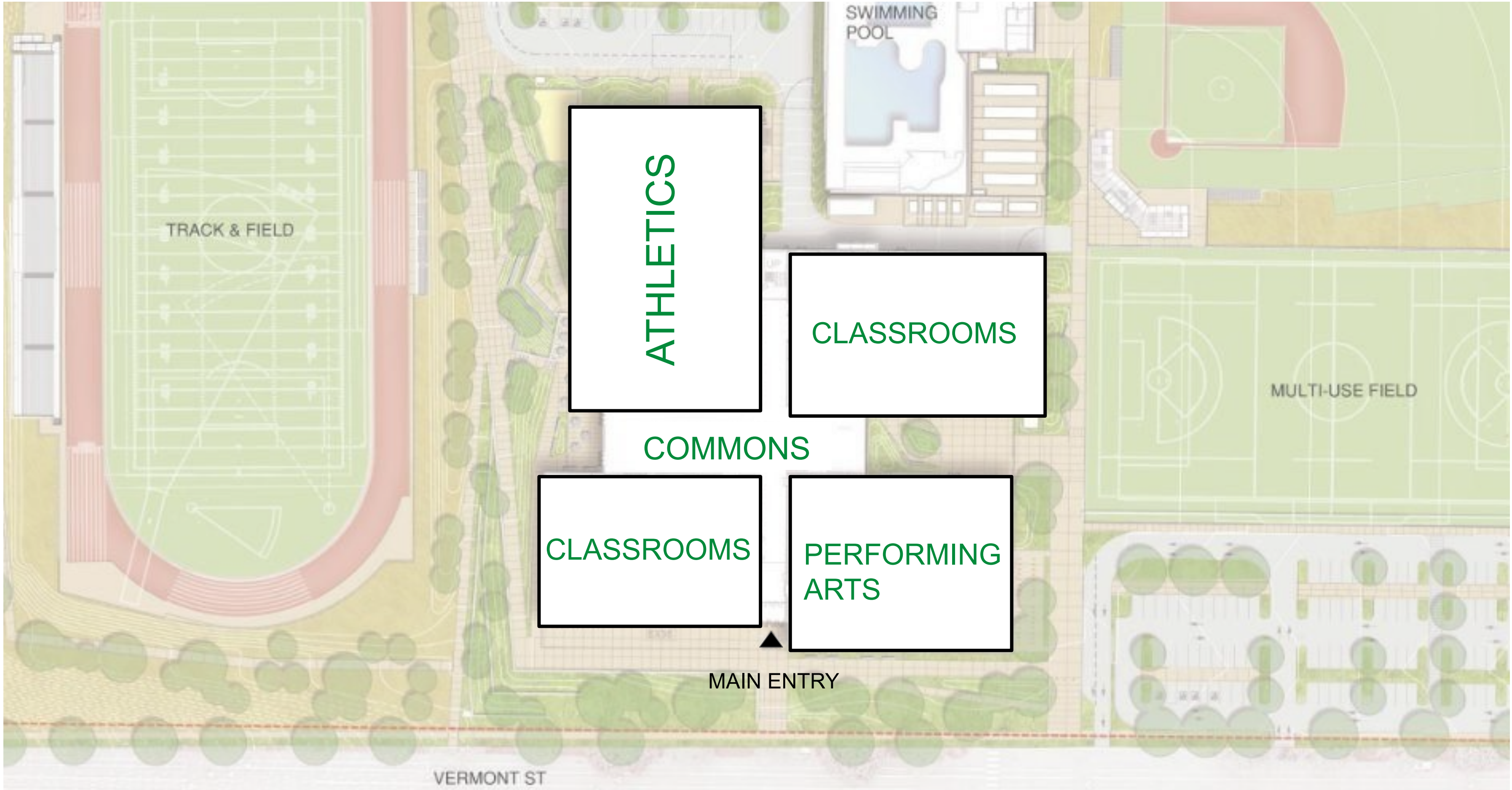

# BASEMENT PLAN

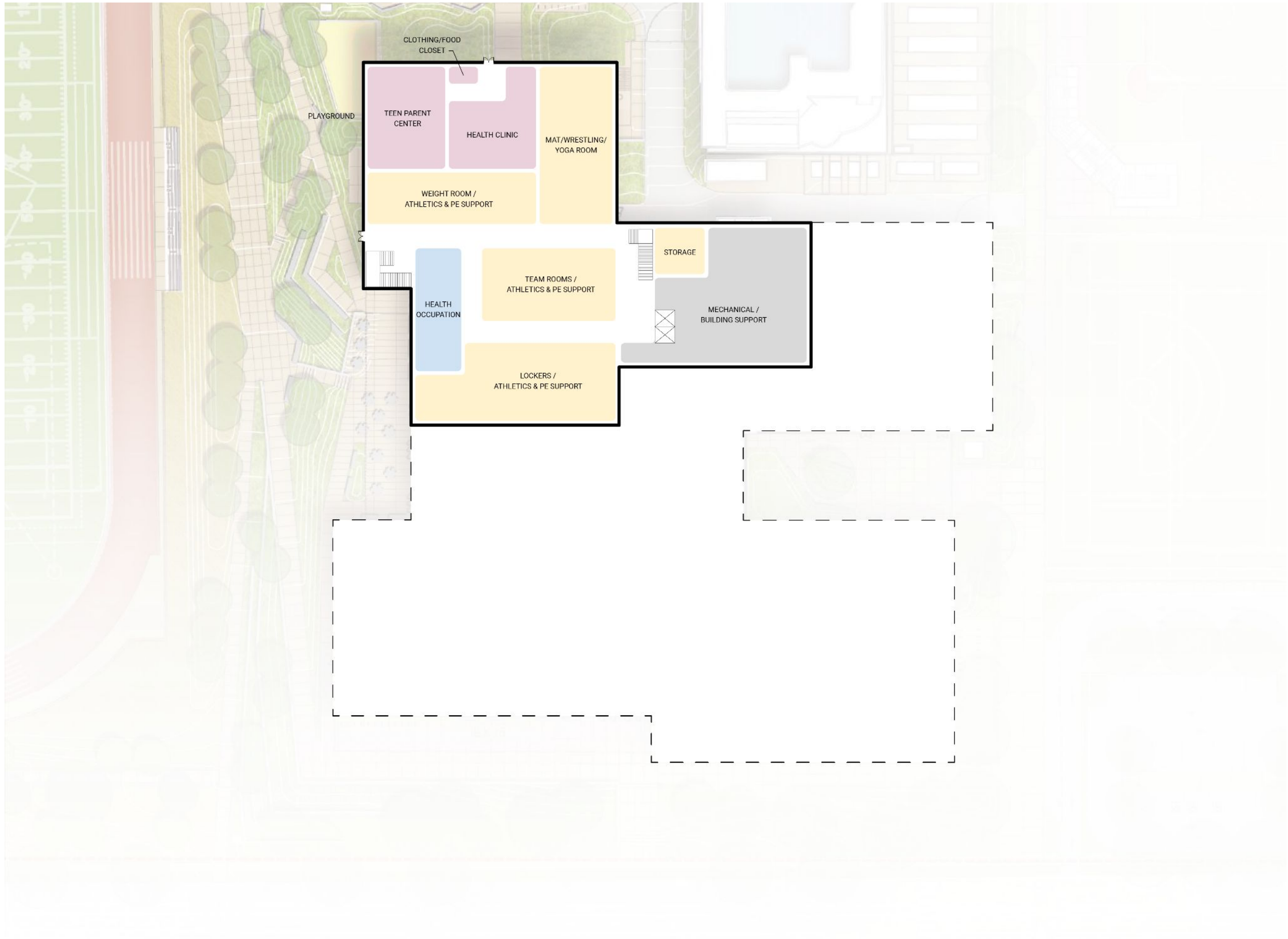

## KEY:

- Performing Arts related spaces
- Athletics related spaces
- Admin and Partners related program and spaces
- Academic related spaces
- Building support related spaces



# 1ST FLOOR PLAN

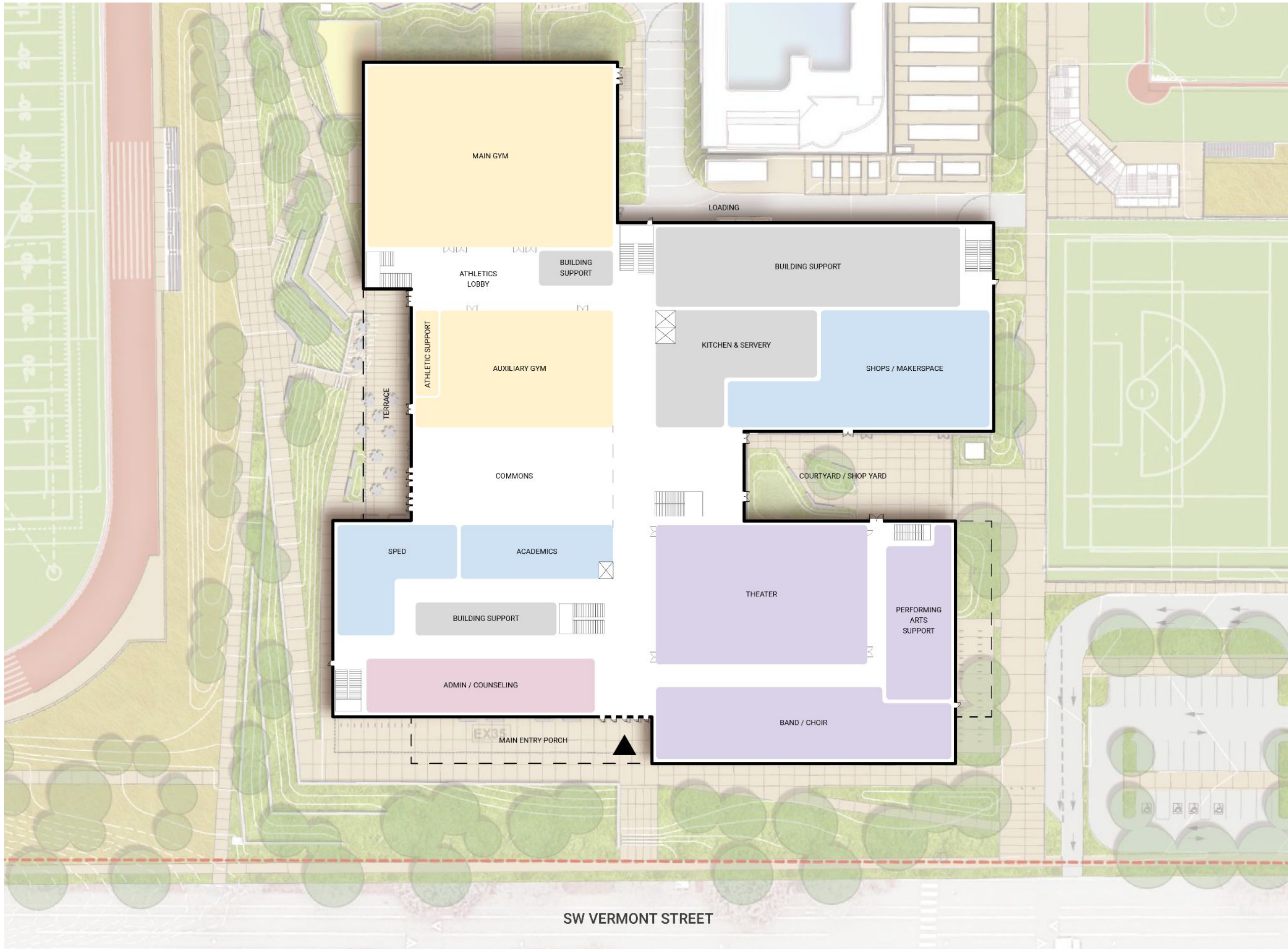

## KEY:



- Performing Arts related spaces
- Athletics related spaces
- Admin and Partners related program and spaces
- Academic related spaces
- Building support related spaces

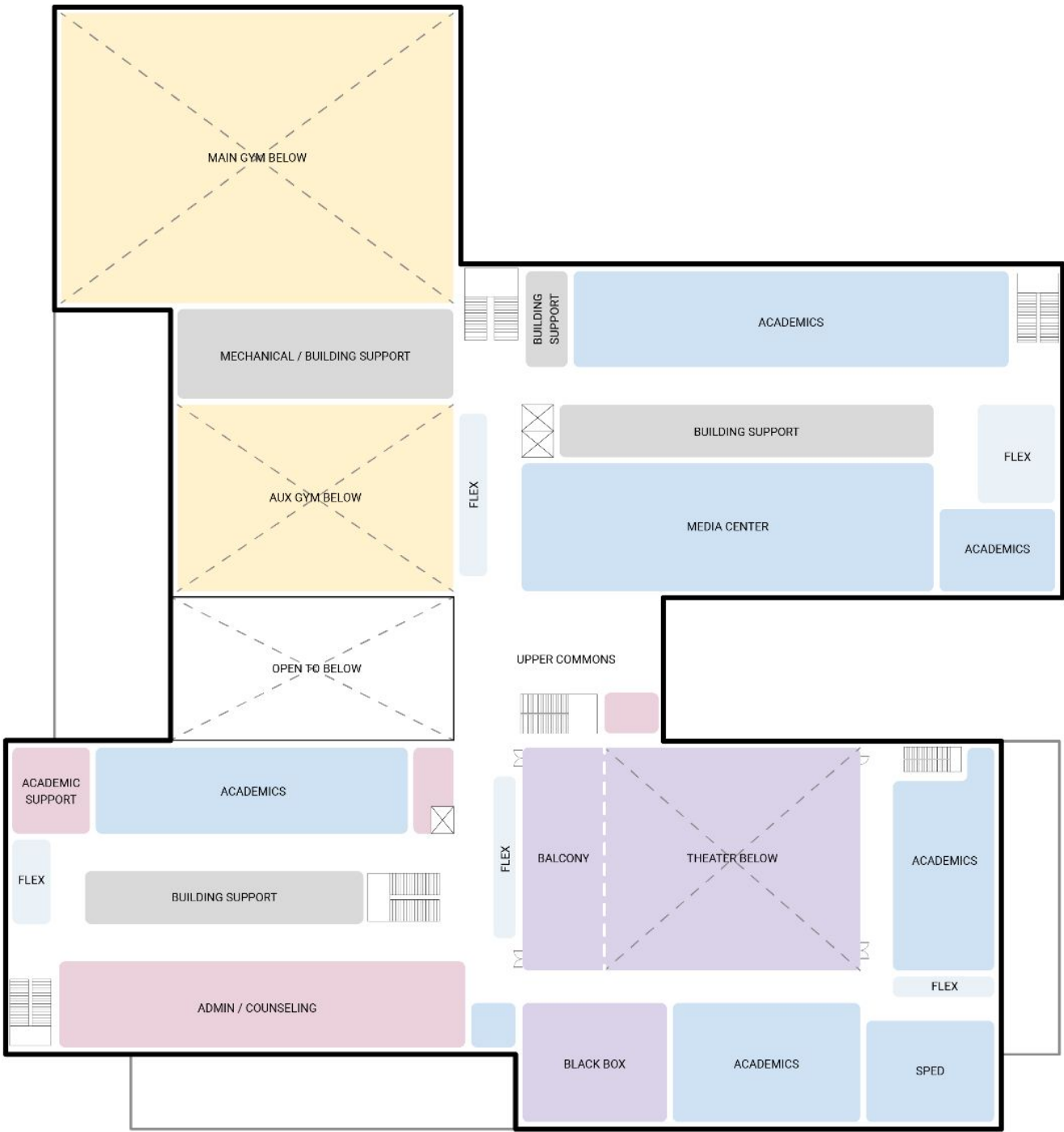

# 2ND FLOOR PLAN

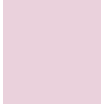
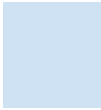
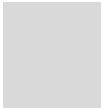

## KEY:

-  Performing Arts related spaces
-  Athletics related spaces
-  Admin and Partners related program and spaces
-  Academic related spaces
-  Building support related spaces



# 3RD FLOOR PLAN

## KEY:

Performing Arts related spaces

Athletics related spaces

Admin and Partners related program and spaces

Academic related spaces

Building support related spaces

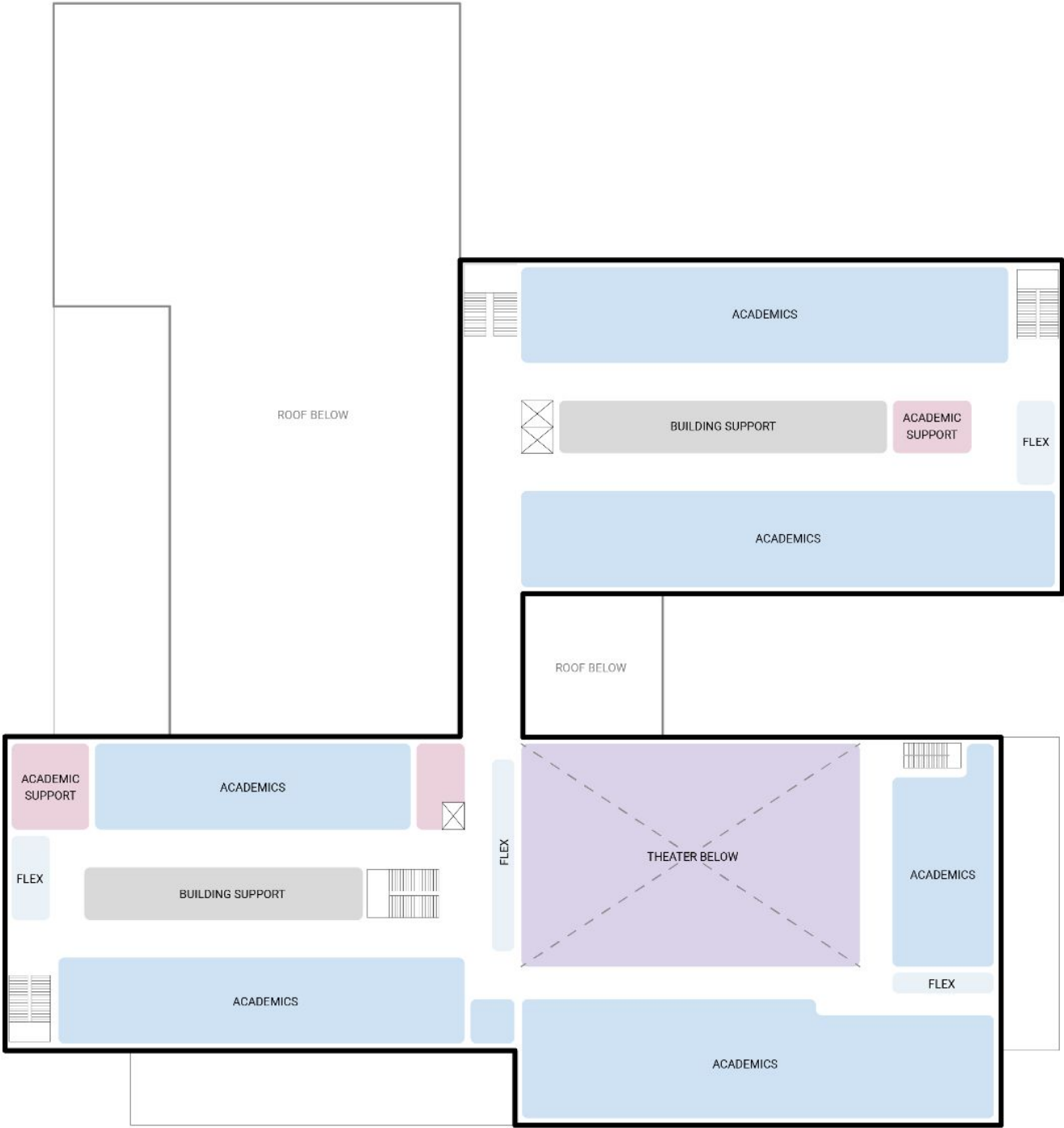

# 4TH FLOOR PLAN

## KEY:

Performing Arts related spaces

Athletics related spaces

Admin and Partners related program and spaces

Academic related spaces

Building support related spaces

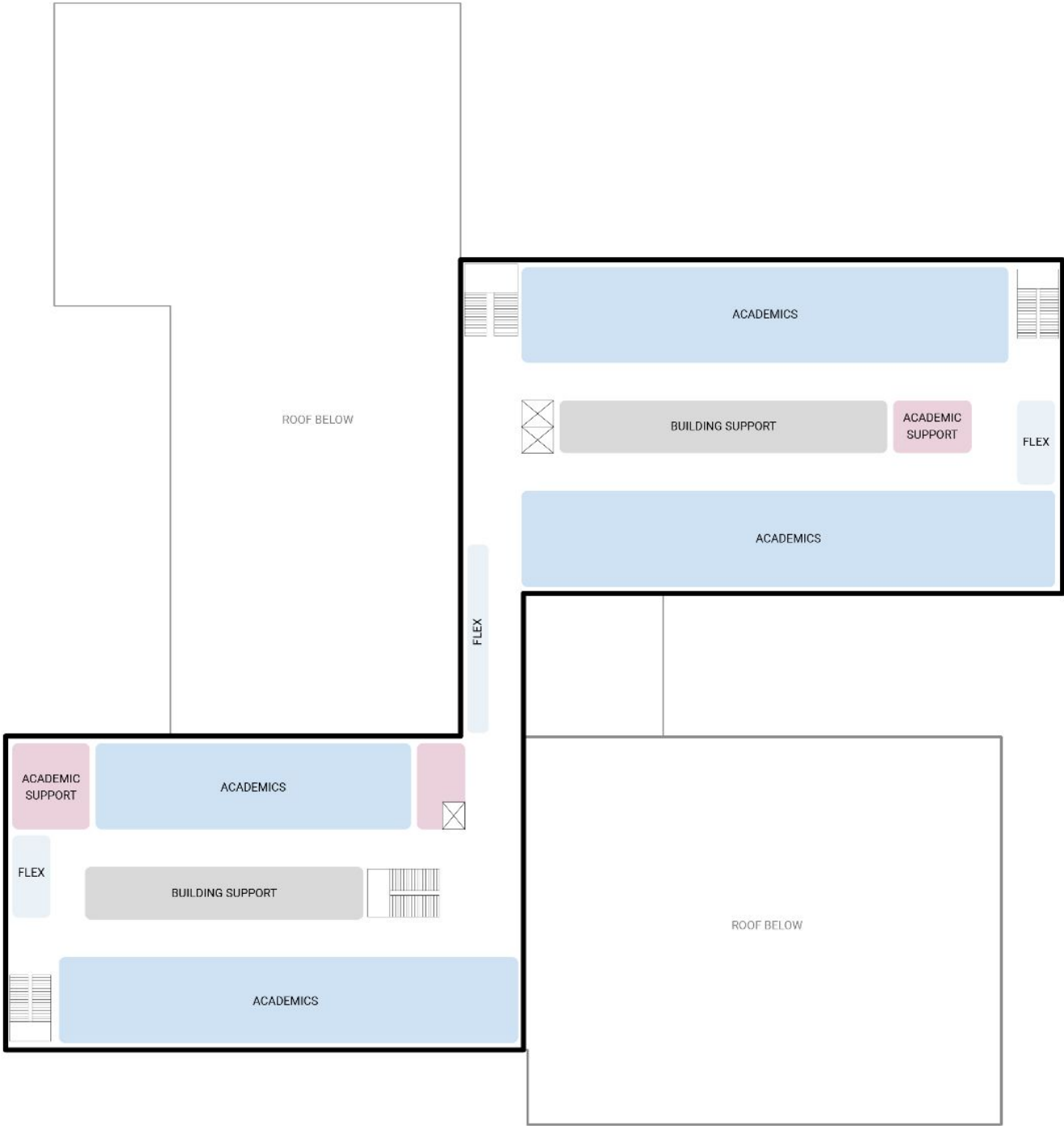

# Exterior Design



WHAT WE'VE HEARD

## Exterior Look & Feel : THIS / NOT THAT!

TAKE THE  
SURVEY!!



## WHAT WE'VE HEARD

# Exterior Look & Feel : THIS / NOT THAT!



## THIS!

- Connect with Nature
- Occupiable Outdoors
- Warmth & Texture
- Prominent Windows
- Feel like a School!
- Inclusivity & Usability
- Maintainability

## NOT THAT!

- Heavy & Cold Materials
- Small/repetitive windows

# NATURAL CONTEXT INSPIRATION



COLOR & MATERIAL STUDIES

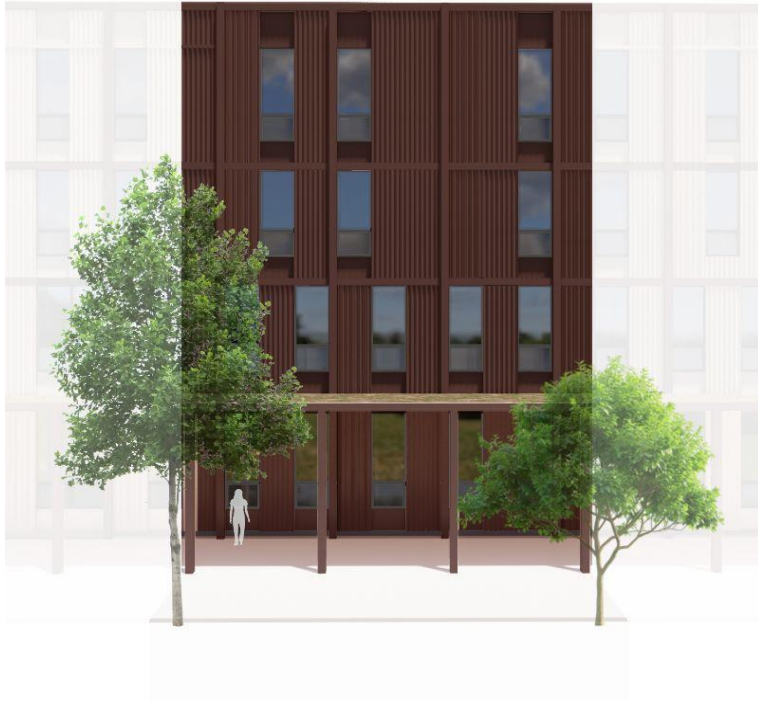

## WEST ELEVATION PERSPECTIVE



## SW PERSPECTIVE



# Interior Design



WHAT WE'VE HEARD

TAKE THE SURVEY!!

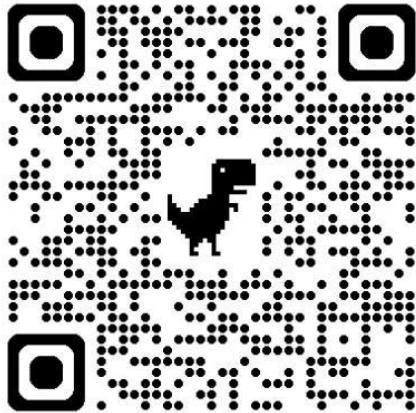

What Makes a Space Welcoming and Comfortable?

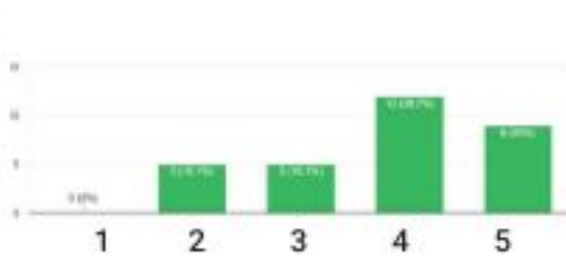

2.2  
Generally people liked this space for its warmth, use of wood, daylight, and approachability. Many noted that the reception desk is off to the side, making it more informal. Some were worried that it's not straightforward and obvious enough for the reception.

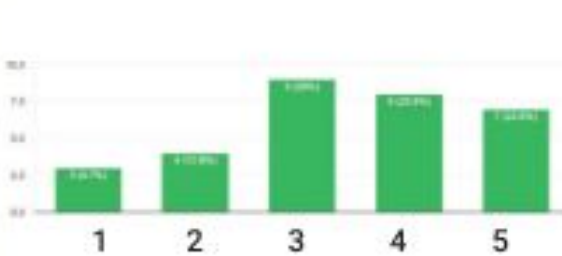

4.5  
Generally people like the wide, well lit pathways and well lit entrance and windows for night use. Many people wish to see more places to rest/sit in this area to encourage casual gathering or make it more comfortable for waiting.

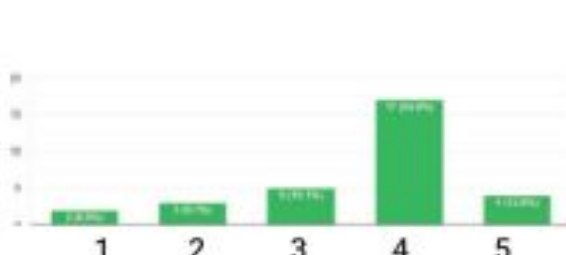

3.1  
A lot of people love the color and playfulness of this space. The different scales of stairs, alcoves, playful lighting design all contribute to a fun space. Some feel like the contrast is too harsh, the colors too juvenile, and the surfaces too hard.

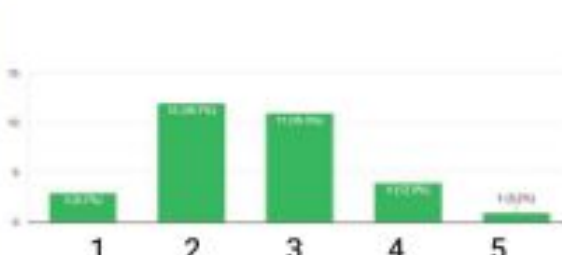

4.6  
Generally this space feels stark and uncomfortable. The ground material looks inaccessible and people feel like it is not supposed to be occupied. The lack of covered areas and lack of color are noted.

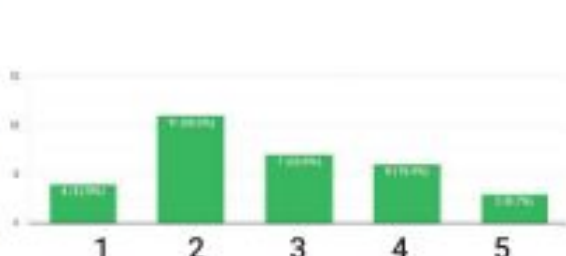

3.2  
This space is generally regarded as less welcoming, it is seen as vast with little that is human scale, the concrete columns are intimidating and the space feels lonely. The warmer wood and brick walls are liked, as well as the daylighting.

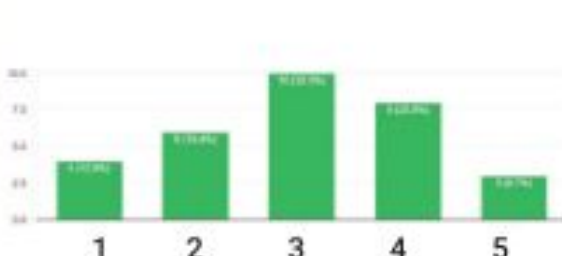

4.7  
Many are drawn to the curvy, fun, and unique forms of this seating option. Others find the position to lay down awkward and uncomfortable and worry about pooling water.

# WHAT WE'VE HEARD

## What Makes a Space Welcoming and Comfortable?



- Natural Light
- Variety of Seating Options
- Human Scale & Proportion
- Accessibility
- Thoughtful Art & Color
- Inclusive Signage
- Flexible Spaces
- Balance Aesthetics & Functionality

## INTERIOR VIEW - COMMONS



## INTERIOR VIEW - COMMONS

Colors and materials shown are placeholders!



# INTERIOR VIEW - COMMONS



## INTERIOR VIEW - COMMONS



## WEST TERRACE / EXTERIOR COMMONS



NEXT STEPS

**Design Team** issuing Schematic Design, starting cost estimating

**Listening Session Recruitment** Ongoing

**Community Design Workshop #5** December 8th

**Additional Feedback?**

Website: [pps.net/IdaBWellsBond](https://pps.net/IdaBWellsBond)

Email: [WellsBond@pps.net](mailto:WellsBond@pps.net)

Please visit the stations  
Take the surveys  
Ask questions  
Leave comments

**STATIONS**

General  
Updates &  
Questions

Site  
Design

Exterior  
Look & Feel

Plan  
Updates

Comfortable  
+Welcoming  
Spaces

Commons  
Design

Community  
Engagement

Thank you!

